

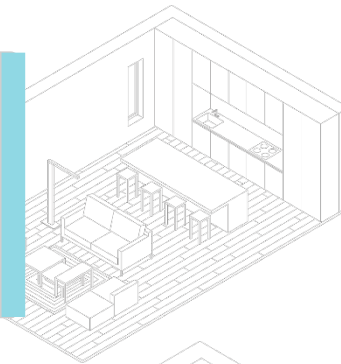

Address 631 Regal Park NE, Calgary, AB
Date September 5, 2019 | 15:30
Name Team Penley McNaughton | Re/Max Real Estate (Central)
Email team@calgaryexperts.com
Phone 403.555.1234

FLOOR TOTALS

Main Level	496.53 sqft / 46.13 m2	Total Size	993.06 sqft / 92.26 m2
Upper Level	496.53 sqft / 46.13 m2	Total w/basement	1446.78 sqft / 134.41 m2
Basement Total	453.72 sqft / 42.15 m2	Order Procedure	RECA RMS
*Finished Total	256.76 sqft / 23.85 m2	Exterior Wall Size	NA
Additions	000.00 sqft / 00.00 m2	Order Type	Row Townhouse



ROOM DIMENSIONS

Kitchen	11'6" X 10'6" ft/in	M	Laundry & Utilities	21'0" X 9'6" ft/in	B
Dining Area	11'0" X 8'0" ft/in	M	Storage Room	0'0" X 0'0" ft/in	NA
Living Room	16'2" X 12'6" ft/in	M	Wet Bar	0'0" X 0'0" ft/in	NA
Family Room	0'0" X 0'0" ft/in	NA	Deck	0'0" X 0'0" ft/in	NA
Foyer	4'10" X 3'6" ft/in	M	Patio	11'8" X 7'0" ft/in	M
Rec Room	17'2" X 12'0" ft/in	NA	Garage	0'0" X 0'0" ft/in	NA

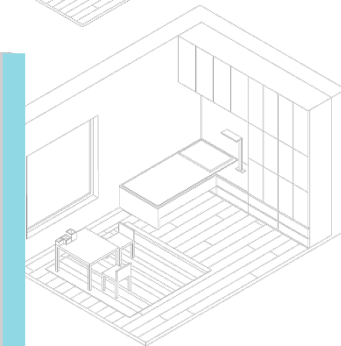

BEDROOM DIMENSIONS

Master	12'6" X 9'8" ft/in	U	Bedroom Four	0'0" X 0'0" ft/in	NA
Bedroom Two	13'10" X 7'0" ft/in	U	Bedroom Five	0'0" X 0'0" ft/in	NA
Bedroom Three	12'6" X 8'0" ft/in	U	Bedroom Six	0'0" X 0'0" ft/in	NA

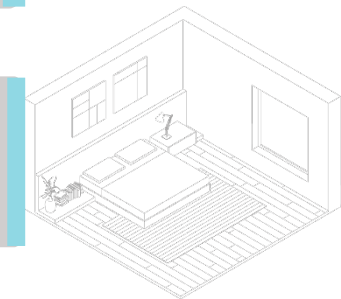

BATHROOM PIECES AND ADDITIONAL ROOMS

1 - Two Piece	M	Additional	0'0" X 0'0" ft/in	NA
0 - Three Piece	NA			
1 - Four Piece	U			
0 - Five Piece	NA			

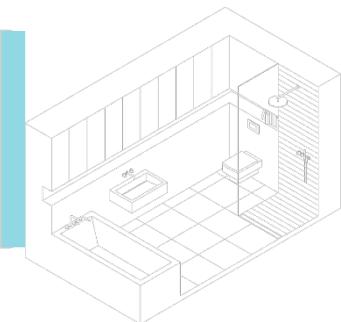

*Insured measurements are based on local guidelines.